



Planning Act 2008
Infrastructure Planning
(Applications Prescribed
Forms and Procedure)
Regulations 2009

North Lincolnshire Green Energy Park

Volume 4

4.4 Works Plans C

PINS reference: EN010116

May 2022

Revision number: 0



The North Lincolnshire Green Energy Park Development Consent Order

4.4 Works Plans C

Date: May 2022

PINS reference: EN010116

Application Document Reference: 4.4

Author: Fichtner Consulting Engineers

CONTENTS

CONTENTS	1
1. INTRODUCTION	2
1.1 General	2
2. SCHEDULE OF PLANS INCLUDED IN THIS APPLICATION DOCUMENT	4

1. INTRODUCTION

1.1 General

1.1.1 The following Plans have been prepared to accompany the application for a Development Consent Order (DCO), made by the Applicant to the Secretary of State (SoS) via the Planning Inspectorate (the Inspectorate).

1.1.2 A detailed description of the Project can be found in Chapter 3 of the ES (**Document Reference 6.2.3**).

1.1.3 These Plans comprise part of the suite of Application documentation and are included in the Application in compliance with Regulation 5(2)(j) of the Infrastructure Planning (Applications: Prescribed Forms and Procedure) Regulations 2009 (the 2009 Regulations), which requires:

(j) a works plan showing, in relation to existing features—

(i) the proposed location or (for a linear scheme) the proposed route and alignment of the development and works; and

(ii) the limits within which the development and works may be carried out and any limits of deviation provided for in the draft order;

1.1.4 These Plans are also being submitted under Regulation 5(4) of the 2009 Regulations which states:

"Where a plan comprises three or more separate sheets a key plan must be provided showing the relationship between the different sheets."

1.1.5 To assist the interpretation of these Plans, a key plan shows ten separate sheets which cover the Order Limits. Where there are no works shown on a separate sheet, "Sheet X Not Used" is shown on the key plan. Only the sheets showing relevant information are provided.

1.1.6 The Works Plans are set up to allow examination of the scheme in three components:

- Works Plans A – the new energy producing infrastructure and associated infrastructure within the Energy Park Land.
 - Work No .1 ERF & Infrastructure
 - Work No. 1A Stacks
 - Work No. 1B Carbon Capture
 - Work No. 1C Visitor's Centre
 - Work No. 1D ACC
 - Work No. 2 Residue Handling and Treatment Facility and Concrete Block Manufacture

- Work No. 5 New Access Road and Highway Improvements
- Work No. 6 Plastic Recycling Facility
- Work No. 7 Hydrogen Production & Gas Injection Facility
- Work No. 8 Vehicle Refuelling Station
- Work No. 9 Battery Storage
- Work No. 10 Private Wire Network
- Work No. 11 District Heating Network
- Work No. 12 Landscaping and Ecological Works
- Work No. 12A Habitat Creation
- Work No. 13 Flood Defences and SUDS
- Work No. 14 Utility Construction and Diversions; and
- Work No. 15 Laydown Areas
- Works Plans B – the district heating and private wire networks and grid connection:
 - Work No. 10 Private Wire Network (including Private Wire Network Option A and Option B)
 - Work No. 11 District Heating Network (including District Heating Network Option A and Option B)
 - Work No. 14 Utility Construction and Diversions; and
 - Work No. 15 Laydown Areas
- Works Plans C – the railway reinstatement works and associated works
 - Work No. 3 Railway Reinstatement Works
 - Work No. 4 Railhead
 - Work No. 12 Landscaping and Ecological Works
 - Work No. 12A Habitat Creation; and
 - Work No. 14 Utility Construction and Diversions

1.1.7

These Plans are part of the Application documentation and should be read alongside and are informed by the other Application documents.

2. SCHEDULE OF PLANS INCLUDED IN THIS APPLICATION DOCUMENT

Drawing Number	Drawing Title	Revision
NLGEP-FCE-XX-XX-DR-Y-2001	Key Plan C	P0
NLGEP-FCE-XX-XX-DR-Y-2002	Works Plans C1	P0
NLGEP-FCE-XX-XX-DR-Y-2003	Works Plans C2	P0
NLGEP-FCE-XX-XX-DR-Y-2004	Works Plans C3	P0
NLGEP-FCE-XX-XX-DR-Y-2005	Works Plans C4	P0
NLGEP-FCE-XX-XX-DR-Y-2006	Works Plans C5	P0
NLGEP-FCE-XX-XX-DR-Y-2007	Works Plans C6	P0
NLGEP-FCE-XX-XX-DR-Y-2008	Works Plans C7	P0
NLGEP-FCE-XX-XX-DR-Y-2009	Works Plans C8	P0
NLGEP-FCE-XX-XX-DR-Y-2010	Works Plans C9	P0

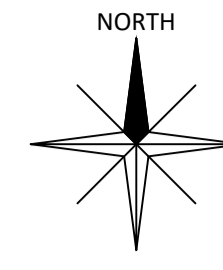

NOTES
OS Licensing information for OS CAD/GIS & raster data orders -
© crown copyright and database rights 2021 OS Licence 100035409

LEGEND
ORDER LIMITS

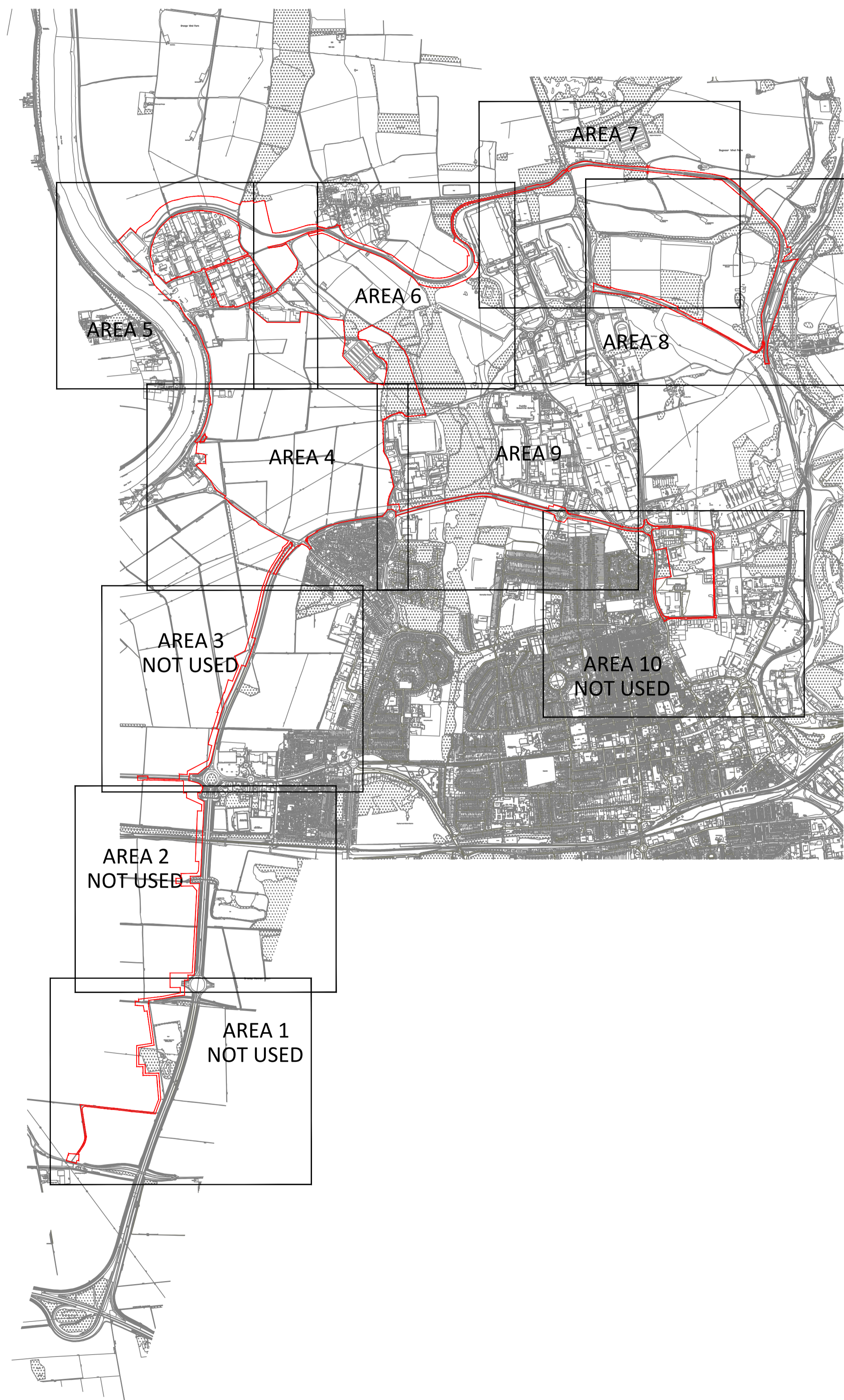

PO	FOR DCO SUBMISSION	17.02.22	AO1	DTW/CAB
Rev	Description	Date	Iss'd	App'd

DCO SUBMISSION

Project Stage

INFORMATION

Status of Drawing

Client



NORTH LINCOLNSHIRE GREEN ENERGY PARK
Level 33, Euston Tower, 296 Euston Road, London, NW1 3DP

LD A DESIGN GSDA ERM FICHTNER CONSULTING ENGINEERS

BURO HAPPOLD northern planners bowland ecology

Client: NORTH LINCOLNSHIRE GREEN ENERGY PARK LTD
 Consultant: FICHTNER CONSULTING ENGINEERS
 Project: NORTH LINCOLNSHIRE GREEN ENERGY PARK
 Dwg Title: KEY PLAN C

Planning Inspectorate No. EN010116 Scale: A1
 1:20,000

Drawn/Designed By: AO1 Checked By: DTW Approved By: CAB

Drawing No. NLGEP-FCE-XX-XX-DR-Y-2001 Revision PO

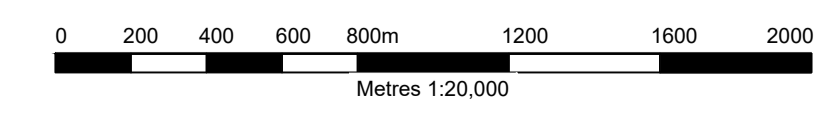

Continuation on C2 dwg No.
NLGEP-FCE-XX-XX-DR-Y-2003

Planning Act 2008
The Infrastructure Planning
(Applications: Prescribed forms and Procedure) Regulations 2009
Regulation: 5(2)(j)

NOTES
OS Licensing information for OS CAD/GIS & raster data orders -
© crown copyright and database rights 2021 OS Licence 100035409

LEGEND
ORDER LIMITS

WORK	DESCRIPTION	LIMITS OF DEVIATION
WORK No. 4	RAILHEAD	

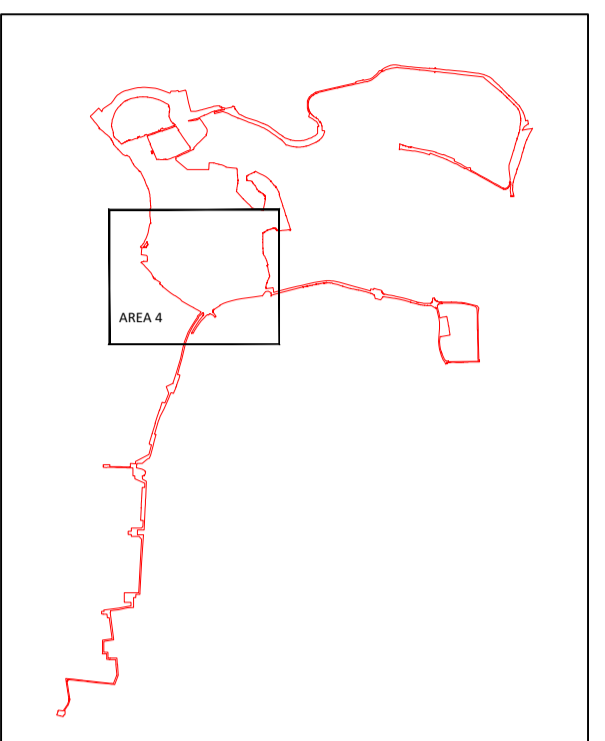

KEY PLAN

PO	FOR DCO SUBMISSION	17.02.22	AO1	DTW/CAB
Rev	Description	Date	Iss'd	Rev'd / Appl'd

DCO SUBMISSION

INFORMATION

Client

Level 33, Euston Tower, 296 Euston Road, London, NW1 3DP

LD&DESIGN GSDA FICHTNER
ERM CONSULTING ENGINEERS LTD

BURO HAPPOLD northern planners bowland ecology

Client: NORTH LINCOLNSHIRE GREEN ENERGY PARK LTD
Consultant: FICHTNER CONSULTING ENGINEERS
Project: NORTH LINCOLNSHIRE GREEN ENERGY PARK
Dwg Title: WORKS PLANS C1

Planning Inspectorate No. EN010116	Scale@A1 1:2500
Drawn/Designed By: AO1	Checked By: DTW
Approved By: CAB	Revision PO

NLGEP-FCE-XX-XX-DR-Y-2002

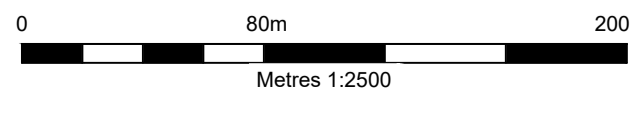
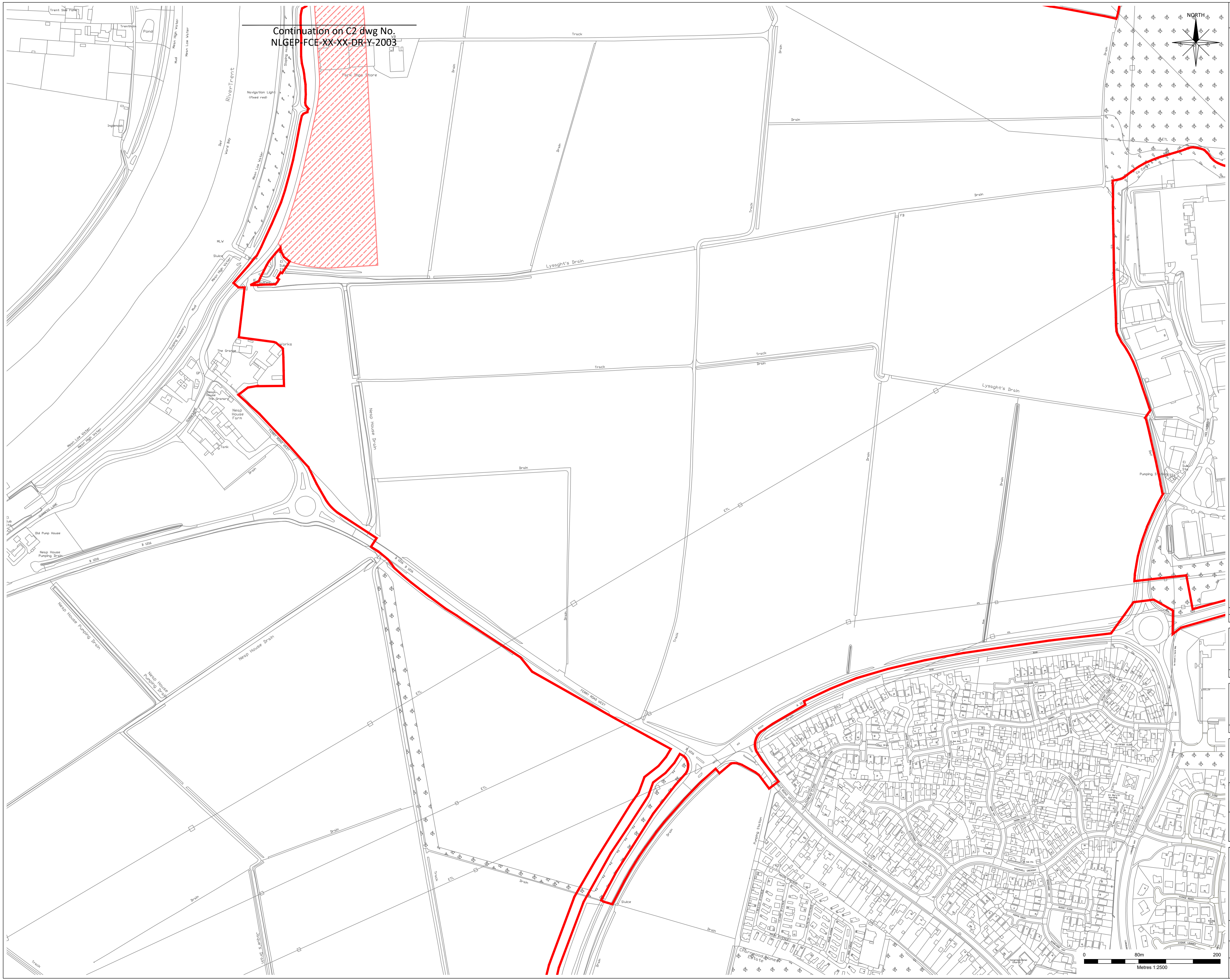

Approved/Issued: 21/01/24 - 1:through/20/development/Support/000 - Drawing/Design/for/Client/Review/31/04/2024/01/NLGEP/Works/Plans/C1/Dwg

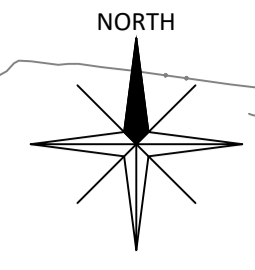
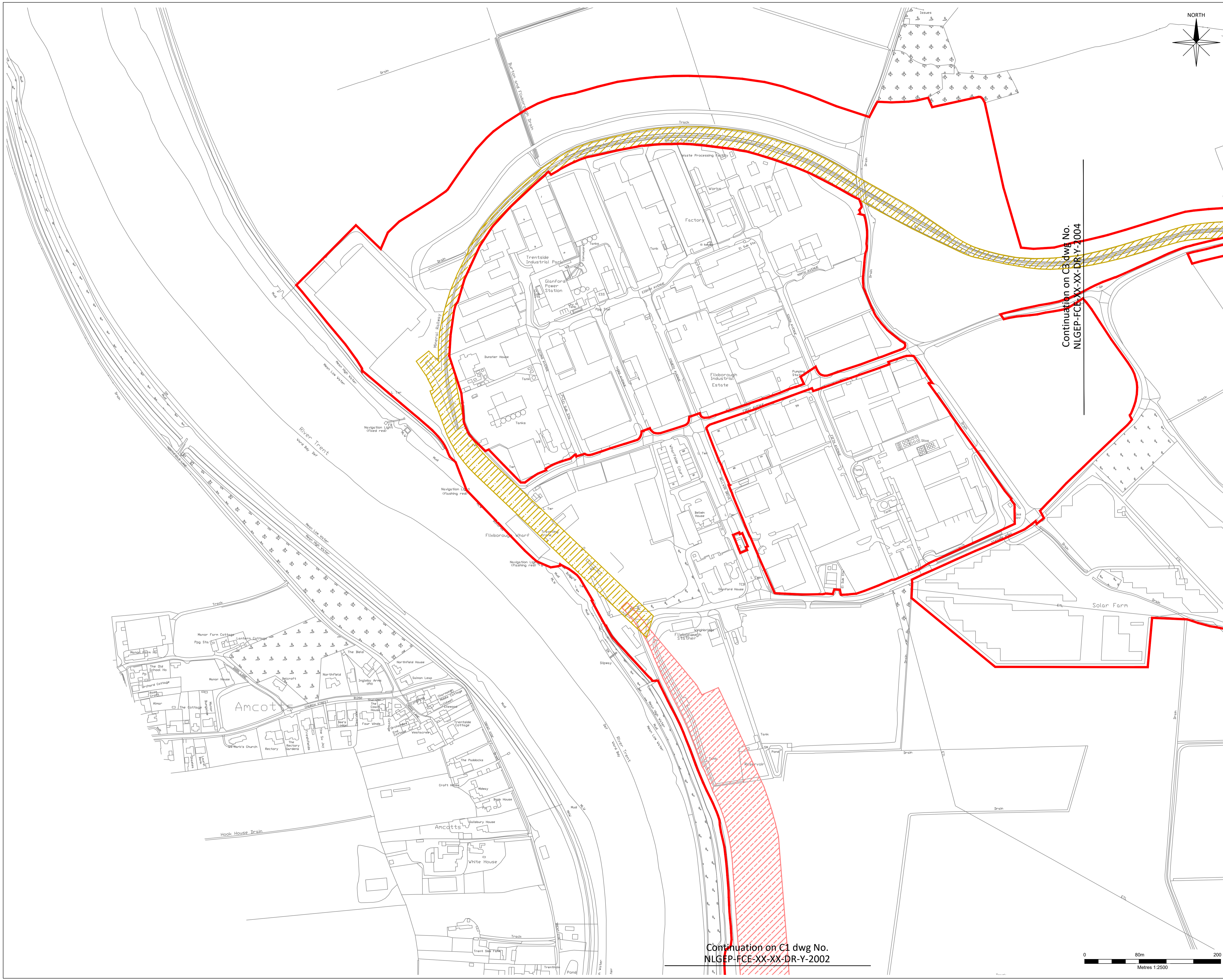

Planning Act 2008
The Infrastructure Planning
(Applications: Prescribed forms and Procedure) Regulations 2009
Regulation: 5(2)(j)

NOTES
OS Licensing information for OS CAD/GIS & raster data orders -
© crown copyright and database rights 2021 OS Licence 100035409

LEGEND

WORK	DESCRIPTION	LIMITS OF DEVIATION
WORK No. 3	RAILWAY REINSTATEMENT WORKS	
WORK No. 4	RAILHEAD	

KEY

ORDER LIMITS

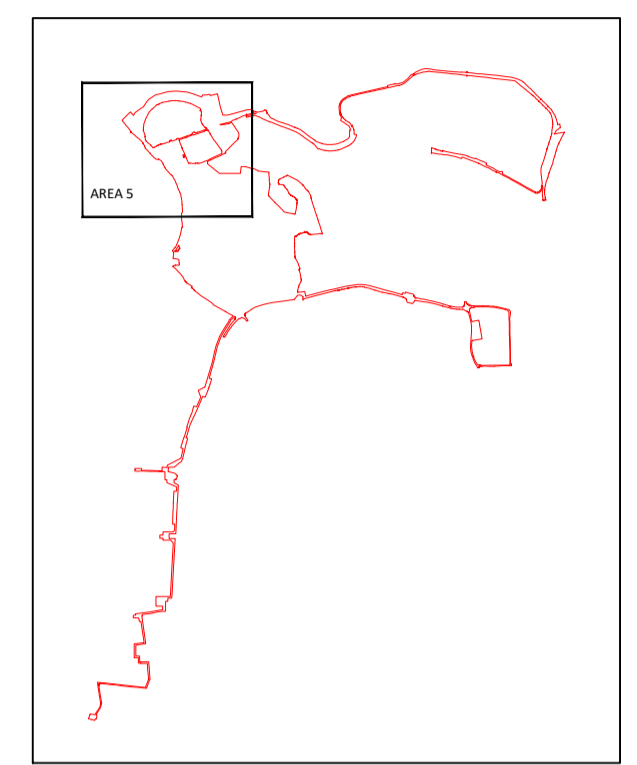

Continuation on C3 dwg No. NLGEP-FCE-XX-XX-DR-Y-2004

Continuation on C1 dwg No. NLGEP-FCE-XX-XX-DR-Y-2002

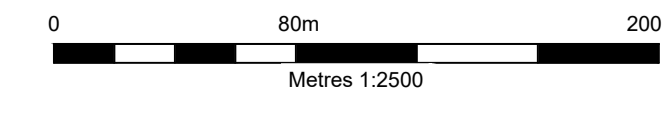

PO	FOR DCO SUBMISSION	17.02.22	AO1	DTW/CAB
Rev	Description	Date	Iss'd	Rev'd

DCO SUBMISSION

Project Stage

INFORMATION

Status of Drawing

Client

Level 33, Euston Tower, 296 Euston Road, London, NW1 3DP

LD&DESIGN GS&A FICHTNER
ERM

BURO HAPPOLD northern planners bowland ecology

Client: NORTH LINCOLNSHIRE GREEN ENERGY PARK LTD
Consultant: FICHTNER CONSULTING ENGINEERS
Project: NORTH LINCOLNSHIRE GREEN ENERGY PARK
Dwg Title: WORKS PLANS C2

Planning Inspectorate No. EN010116	Scale@A1 1:2500
Drawn/Designed By: AO1	Checked By: DTW
Approved By: CAB	Revision PO

As per: Open 15/04/21/1514 - Through EIV Development Support/000 - Drawing/Change for Client Review/31/04/2021/NLGP/Works Plans C2/PO

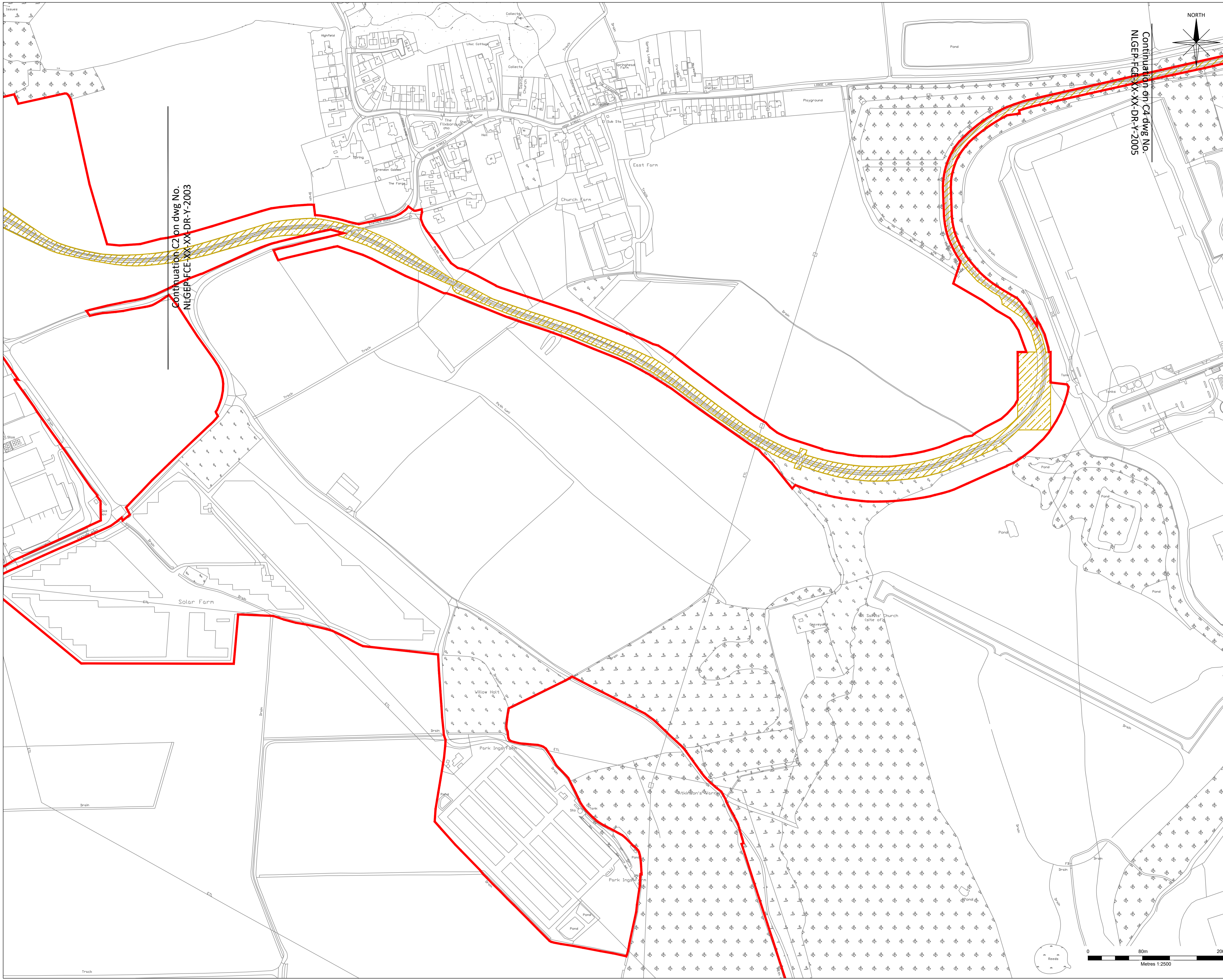

Continuation C2 on dwg No. NLGEP-FCE-XX-XX-DR-Y-2003

Continuation of C4 dwg No. NLGEP-FCE-XX-XX-DR-Y-2005

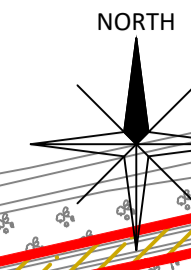

Planning Act 2008
The Infrastructure Planning (Applications: Prescribed forms and Procedure) Regulations 2009
Regulation: 5(2)(j)

NOTES
OS Licensing information for OS CAD/GIS & raster data orders -
© crown copyright and database rights 2021 OS Licence 100035409

LEGEND

WORK	DESCRIPTION	LIMITS OF DEVIATION
WORK No. 3	RAILWAY REINSTATEMENT WORKS	

KEY

ORDER LIMITS

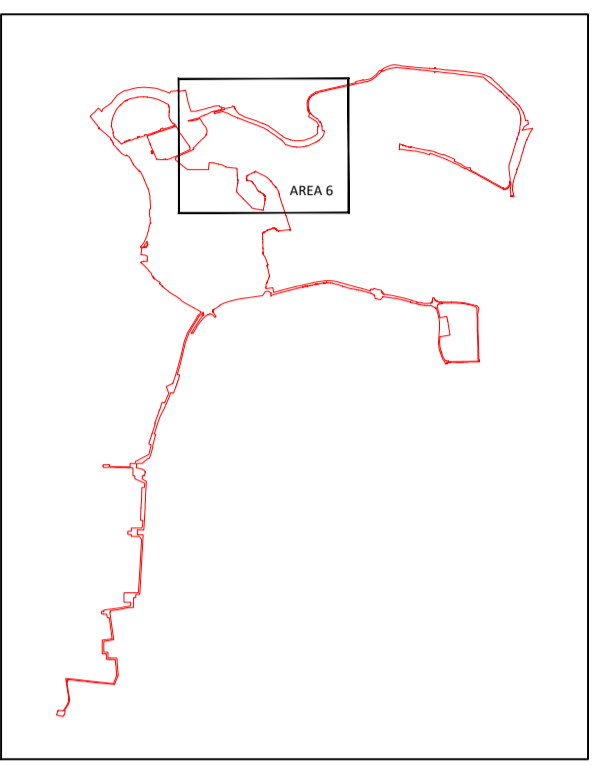

PD	FOR DCO SUBMISSION	17.02.22	AO1	DTW/CAB
Rev	Description	Date	Iss'd	Rev'd

DCO SUBMISSION

INFORMATION

Client



Level 33, Euston Tower, 296 Euston Road, London, NW1 3DP

LD&DESIGN GS&A FICHTNER
ERM CONSULTING ENGINEERS LTD

BURO HAPPOLD northern planners bowland ecology

Client: NORTH LINCOLNSHIRE GREEN ENERGY PARK LTD
Consultant: FICHTNER CONSULTING ENGINEERS
Project: NORTH LINCOLNSHIRE GREEN ENERGY PARK
Dwg Title: WORKS PLANS C3

Planning Inspectorate No. EN010116	Scale@A1 1:2500	
Drawn/Designed By: AO1	Checked By: DTW	Approved By: CAB
Drawing No. NLGEP-FCE-XX-XX-DR-Y-2004	Revision PO	

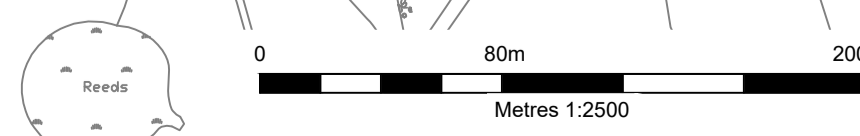

As per Open Access 21/03/14 - Through ERM Development Support/000 - Drawing/Design for Client/Review/31/04/2020/01/NLGP/Works Plans C3/Dwg

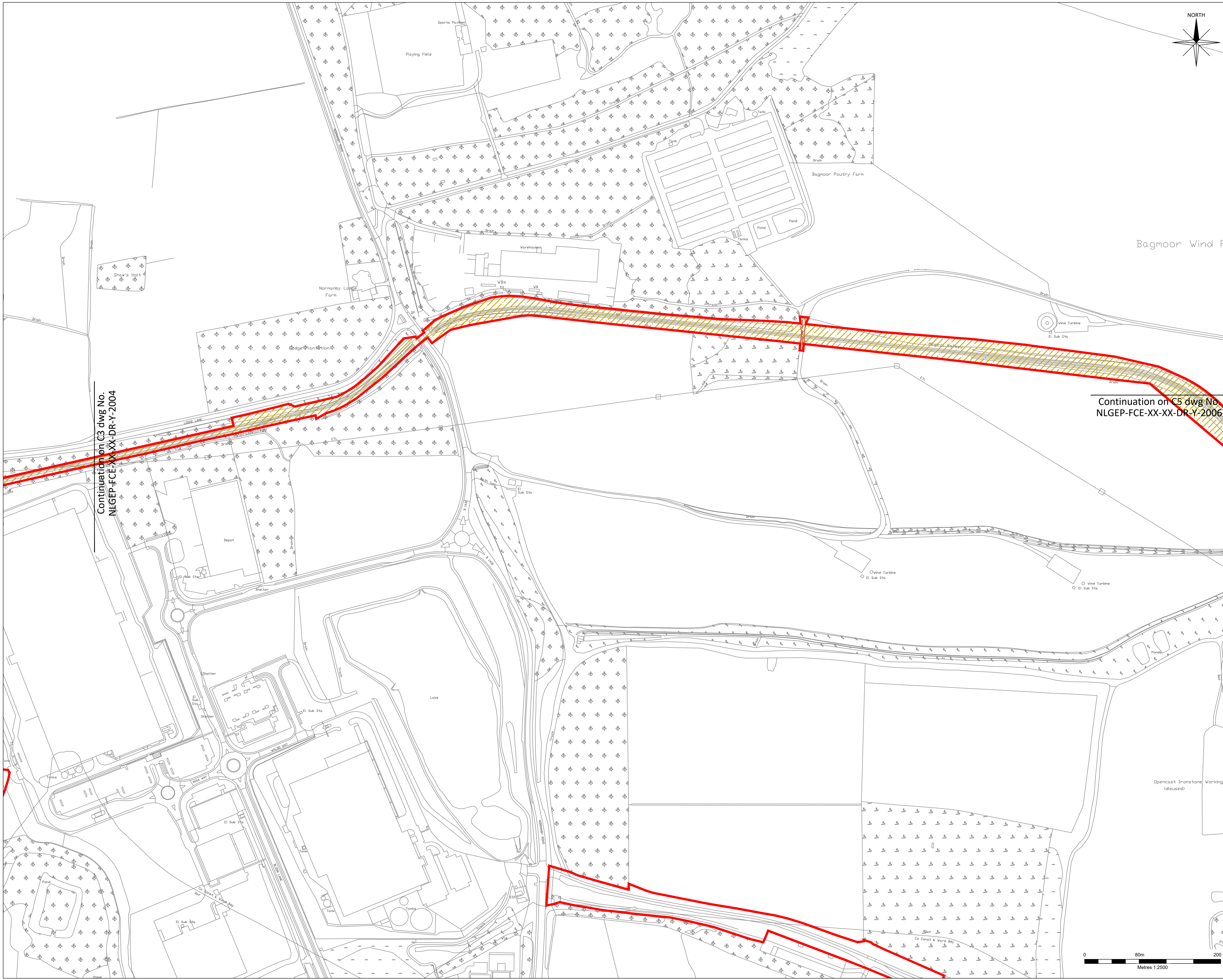

Continuation on C3 dwg No.
NLGEP-FCE-XX-XX-DR-Y-2004

Continuation on C5 dwg No.
NLGEP-FCE-XX-XX-DR-Y-2006

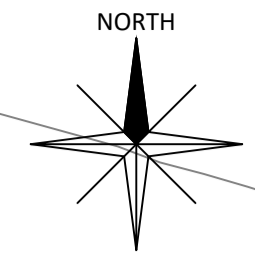

Planning Act 2008
The Infrastructure Planning
(Applications: Prescribed forms and Procedure) Regulations 2009
Regulation: 5(2)(j)

NOTES
OS Licensing information for OS CAD/GIS & raster data orders -
© crown copyright and database rights 2021 OS Licence 100035409

LEGEND

WORK	DESCRIPTION	LIMITS OF DEVIATION
WORK No. 3	RAILWAY REINSTATEMENT WORKS	
WORK No. 14	UTILITY CONSTRUCTION AND DIVERSIONS	

KEY

ORDER LIMITS

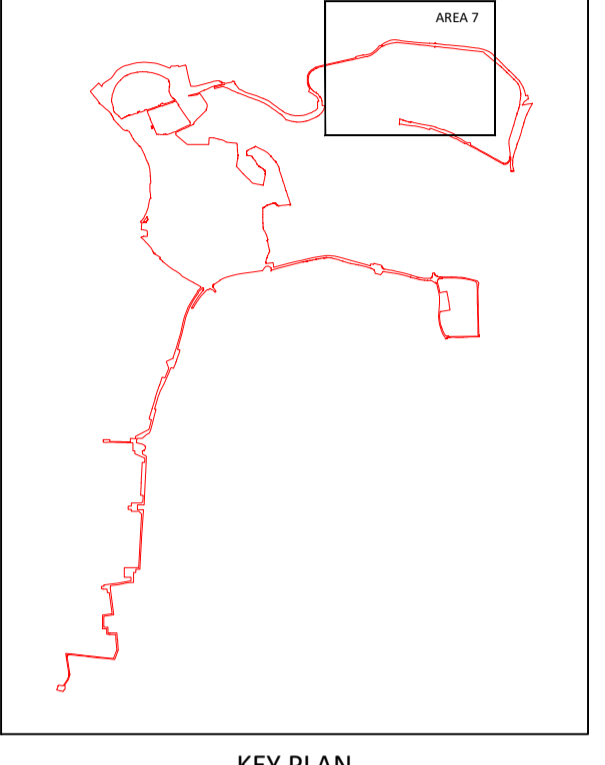

PO	FOR DCO SUBMISSION	17.02.22	AO1	DTW/CAB
Rev	Description	Date	Iss'd	Rev'd

DCO SUBMISSION

INFORMATION

Client

Level 33, Euston Tower, 296 Euston Rd, London, NW1 3DP

LD A DESIGN GSDA FICHTNER ERM

BURO HAPPOLD northern planners bowland ecology

Client: NORTH LINCOLNSHIRE GREEN ENERGY PARK LTD
 Consultant: FICHTNER CONSULTING ENGINEERS
 Project: NORTH LINCOLNSHIRE GREEN ENERGY PARK
 Dwg Title: WORKS PLANS C4

Planning Inspectorate No. EN010116	Scale@A1 1:2500
Drawn/Designed By: AO1	Checked By: DTW
Approved By: CAB	Revision PO
Drawing No. NLGEP-FCE-XX-XX-DR-Y-2005	

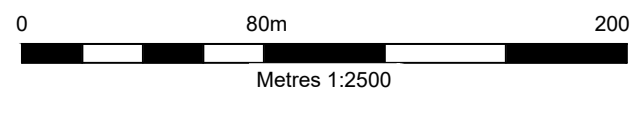

Project: 15/04/2015 - 21/01/2015 - Through EIA Development Support/000 - Drawing/Design for Client/Review/3/15/04/2015/000/000/001/NLGEP/Works Plans C4/Dwg

Continuation on C4 dwg No.
NLGEP-FCE-XX-XX-DR-Y-2005

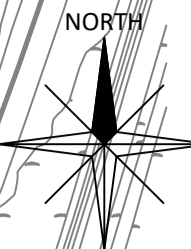

Planning Act 2008
The Infrastructure Planning
(Applications: Prescribed forms and Procedure) Regulations 2009
Regulation: 5(2)(j)

NOTES
OS Licensing information for OS CAD/GIS & raster data orders -
© crown copyright and database rights 2021 OS Licence 100035409

LEGEND
ORDER LIMITS

WORK	DESCRIPTION	LIMITS OF DEVIATION
WORK No. 3	RAILWAY REINSTATEMENT WORKS	
WORK No. 4	RAILHEAD	

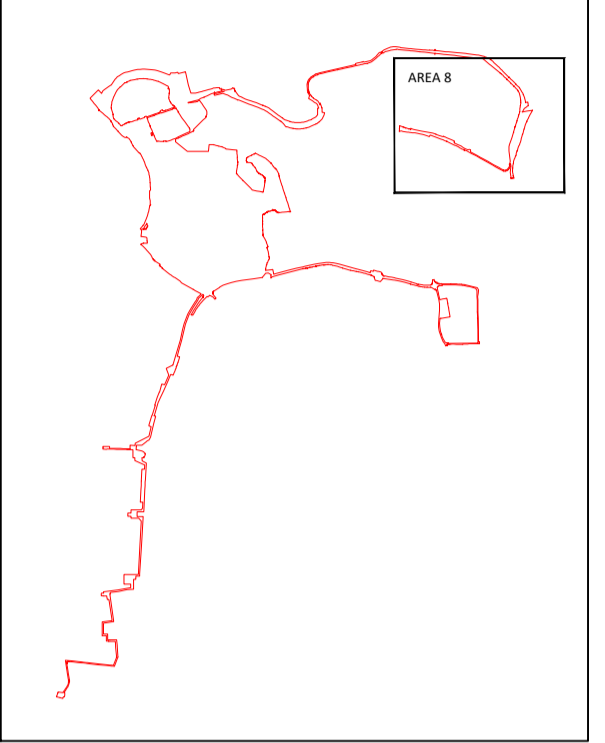

KEY PLAN

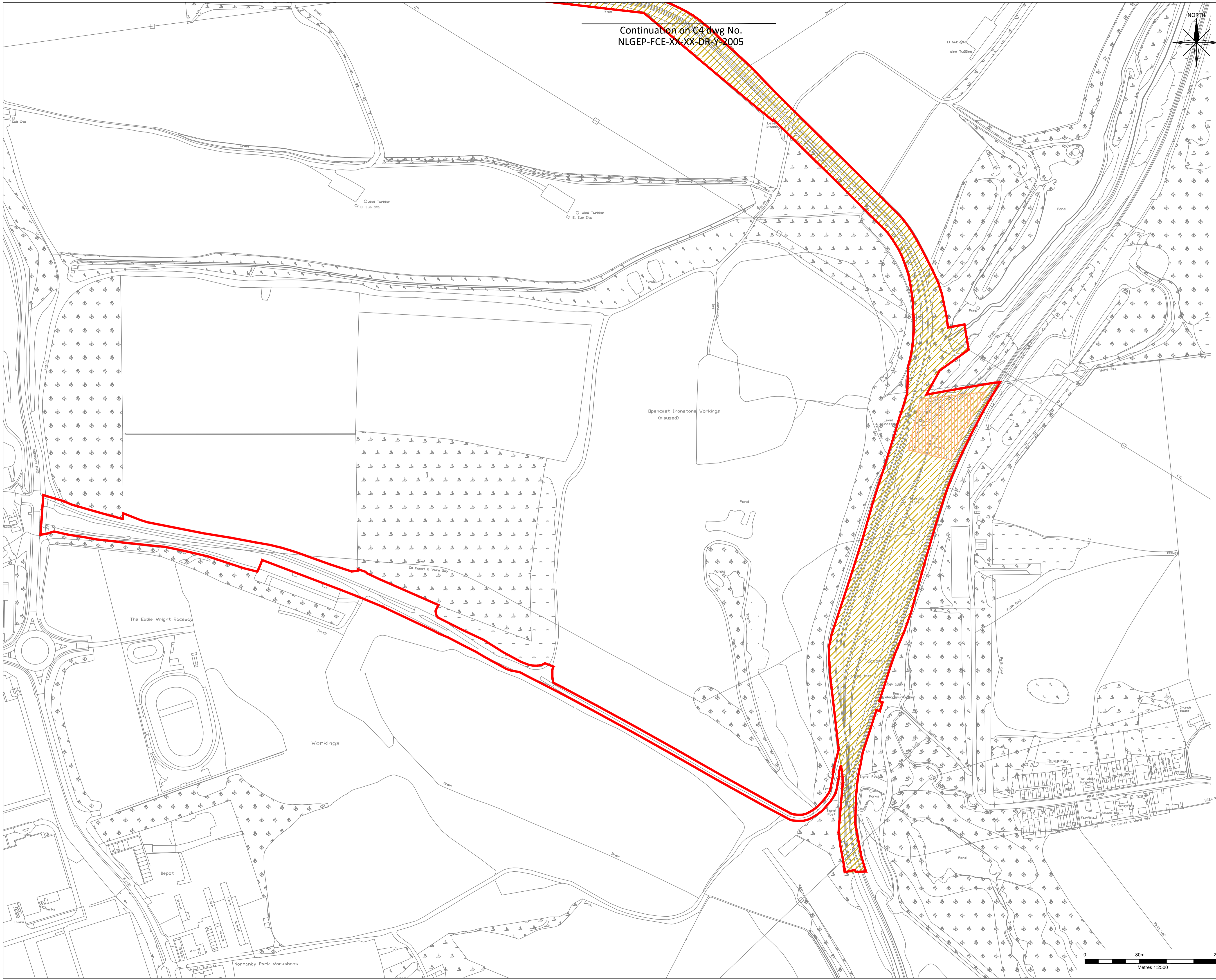

PO	FOR DCO SUBMISSION	17.02.22	AO1	DTW/CAB
Rev	Description	Date	Iss'd	Rev'd

DCO SUBMISSION

Project Stage

INFORMATION

Status of Drawing

Client



NORTH LINCOLNSHIRE
GREEN ENERGY PARK
Level 33, Euston Tower, 296 Euston Road,
London, NW1 3DP

LD&DESIGN GSDA FICHTNER
ERM CONSULTING ENGINEERS

BURO HAPPOLD northern planners bowland ecology

Client: NORTH LINCOLNSHIRE GREEN ENERGY PARK LTD
Consultant: FICHTNER CONSULTING ENGINEERS
Project: NORTH LINCOLNSHIRE GREEN ENERGY PARK
Dwg Title: WORKS PLANS C5

Planning Inspectorate No. EN010116	Scale@A1 1:2500	
Drawn/Designed By: AO1	Checked By: DTW	Approved By: CAB
Drawing No. NLGEP-FCE-XX-XX-DR-Y-2006	Revision PO	

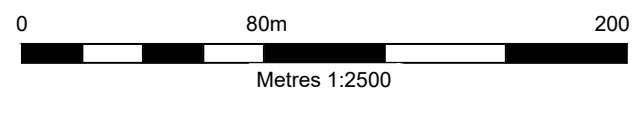

As per Open Access 2015 - Planning Act 2008 (Applications: Prescribed forms and Procedure) Regulations 2009 Regulation 5(2)(j)

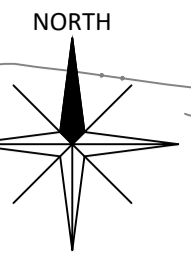
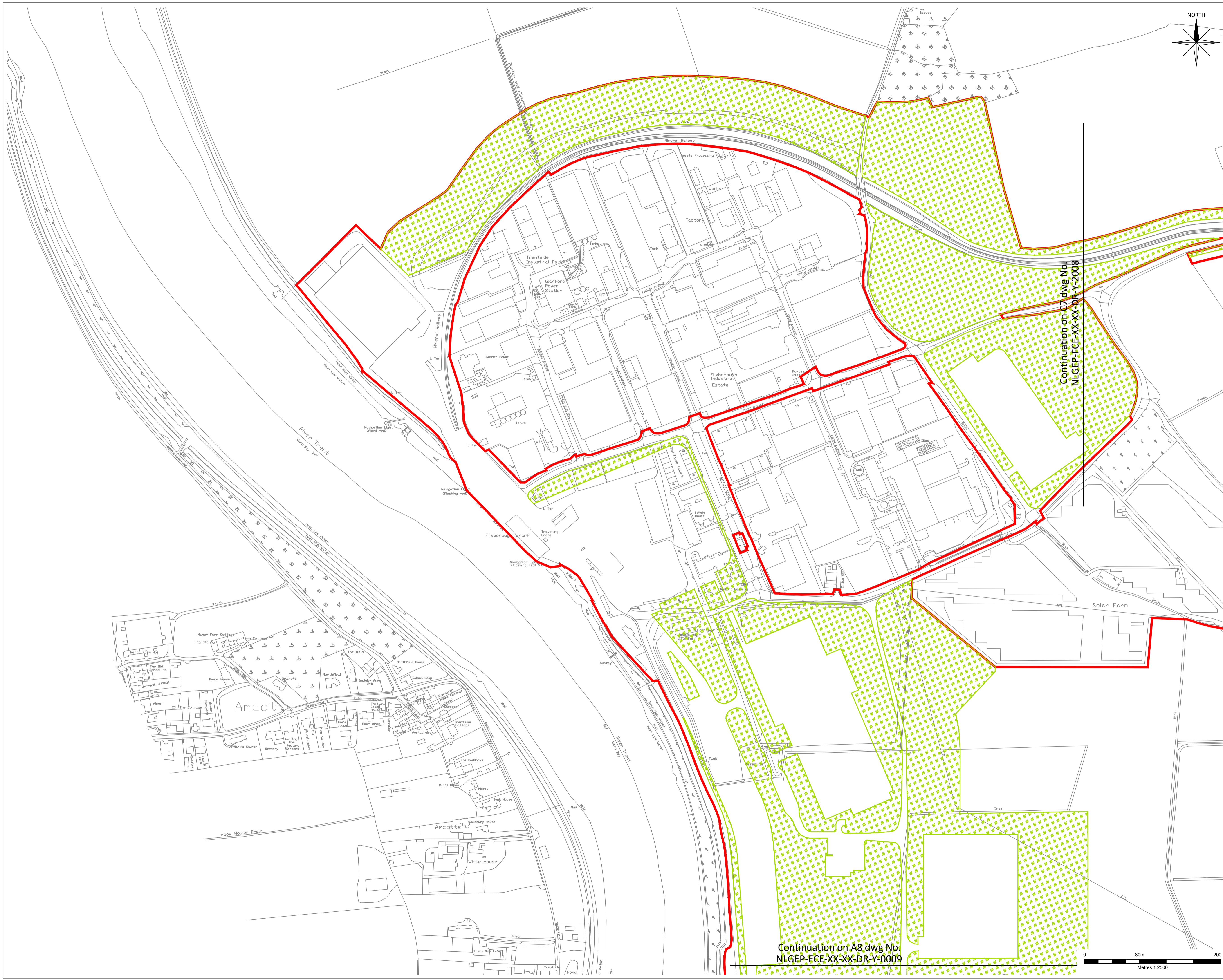

Planning Act 2008
The Infrastructure Planning
(Applications: Prescribed forms and Procedure) Regulations 2009
Regulation: 5(2)(j)

NOTES
OS Licensing information for OS CAD/GIS & raster data orders -
© crown copyright and database rights 2021 OS Licence 100035409

LEGEND

WORK	DESCRIPTION	LIMITS OF DEVIATION
WORK No. 12	LANDSCAPING AND ECOLOGICAL WORKS	

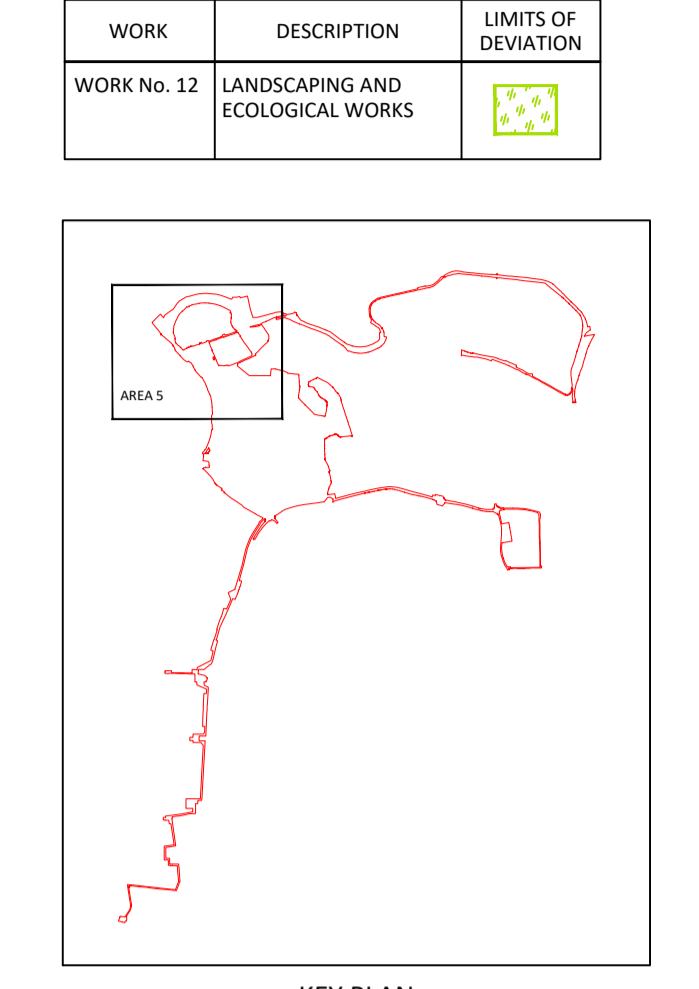

Continuation on C7 dwg No. NLGEP-FCE-XX-XX-DR-Y-2008

Continuation on A8.dwg No. NLGEP-FCE-XX-XX-DR-Y-0009

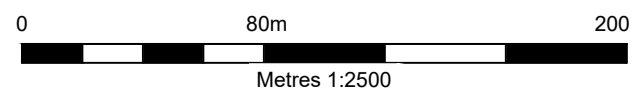

PO FOR DCO SUBMISSION	17.02.22	AO1	DTW/CAB
Rev	Description	Date	Iss'd Rev'd Appl'd

DCO SUBMISSION

Project Stage

INFORMATION

Status of Drawing

Client

Level 33, Euston Tower, 296 Euston Road, London, NW1 3DP

LD&DESIGN GSDA FICHTNER
ERM

BURO HAPPOLD northern planners bowland ecology

Client: NORTH LINCOLNSHIRE GREEN ENERGY PARK LTD
Consultant: FICHTNER CONSULTING ENGINEERS
Project: NORTH LINCOLNSHIRE GREEN ENERGY PARK
Dwg Title: WORKS PLANS C6

Planning Inspectorate No. EN010116 Scale@A1 1:2500

Drawn/Designed By: AO1 Checked By: DTW Approved By: CAB

Drawing No. NLGEP-FCE-XX-XX-DR-Y-2007 Revision PO

As per Open Access 21/12/14 - Through ERM Development Support/000 - Drawing/Design for Client Review/31/04/2020/01 NLGEP Works Plans C6 DWG

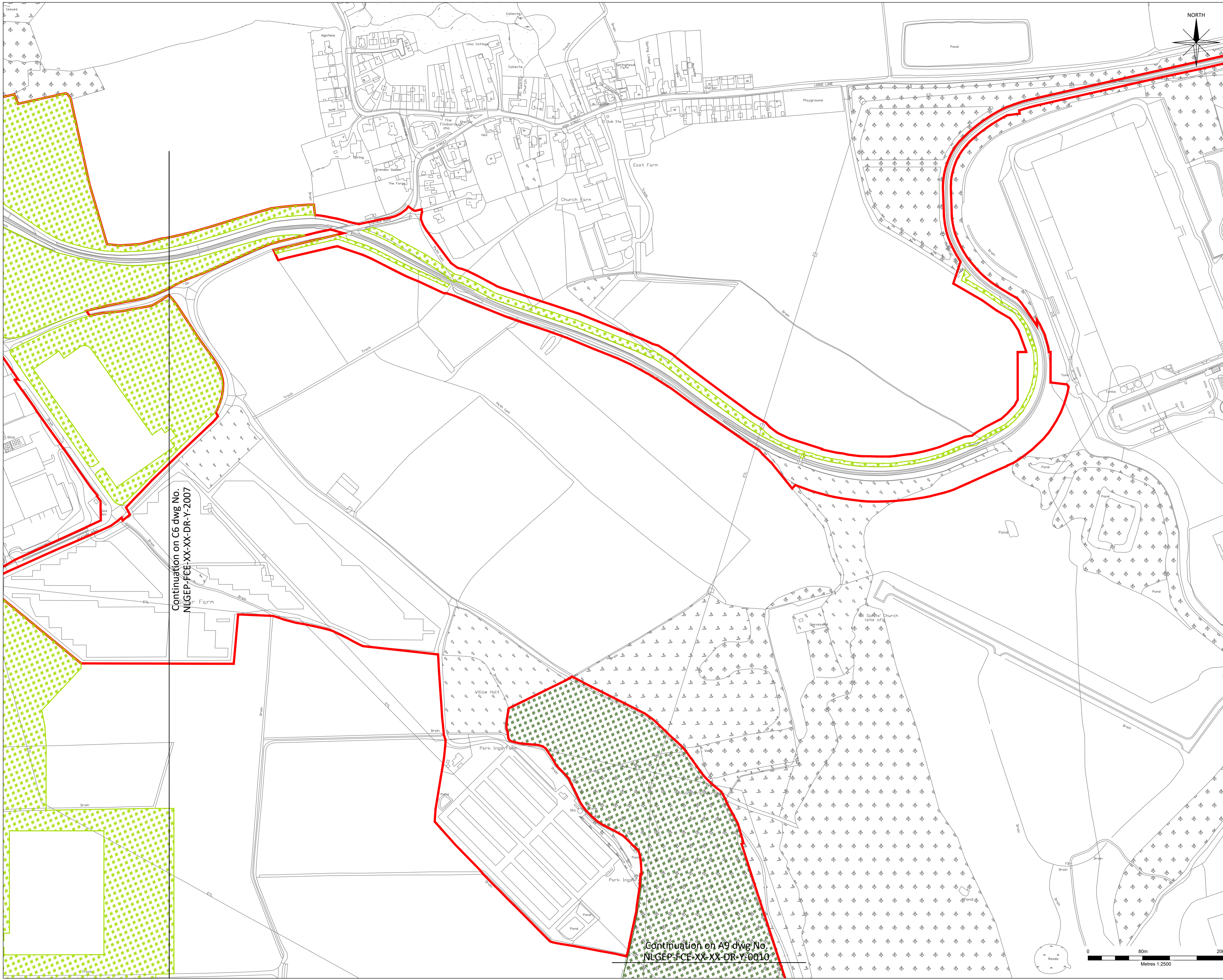

Continuation on C6 dwg No. NLGEP-FCE-XX-XX-DR-Y-2007

Continuation on A9 dwg No. NLGEP-FCE-XX-XX-DR-Y-0010

Planning Act 2008
The Infrastructure Planning
(Applications: Prescribed forms and Procedure) Regulations 2009
Regulation: 5(2)(j)

NOTES
OS Licensing information for OS CAD/GIS & raster data orders -
© crown copyright and database rights 2021 OS Licence 100035409

LEGEND

WORK	DESCRIPTION	LIMITS OF DEVIATION
WORK No. 12	LANDSCAPING AND ECOLOGICAL WORKS	
WORK No. 12A	HABITAT CREATION	

KEY

ORDER LIMITS

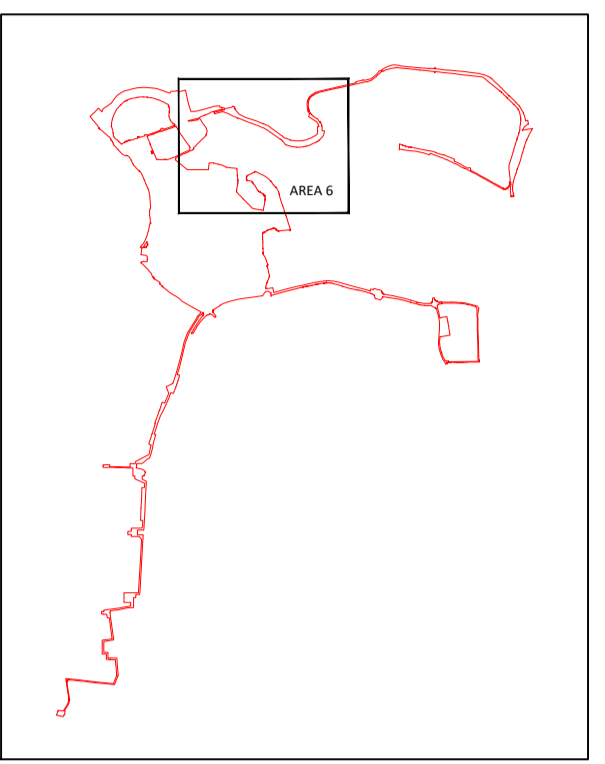

KEY PLAN

PO	FOR DCO SUBMISSION	17.02.22	AO1	DTW/CAB
Rev	Description	Date	Iss'd	Rev'd

DCO SUBMISSION

INFORMATION

Client

Level 33, Euston Tower, 286 Euston Road, London, NW1 3DP

LD&DESIGN GSDA FICHTNER
ERM CONSULTING ENGINEERS LTD

BURO HAPPOLD northern planners bowland ecology

Client: NORTH LINCOLNSHIRE GREEN ENERGY PARK LTD
Consultant: FICHTNER CONSULTING ENGINEERS
Project: NORTH LINCOLNSHIRE GREEN ENERGY PARK
Dwg Title: WORKS PLANS C7

Planning Inspectorate No. EN010116	Scale@A1 1:2500
Drawn/Designed By: AO1	Checked By: DTW
Approved By: CAB	Revision PO
Drawing No. NLGEP-FCE-XX-XX-DR-Y-2008	

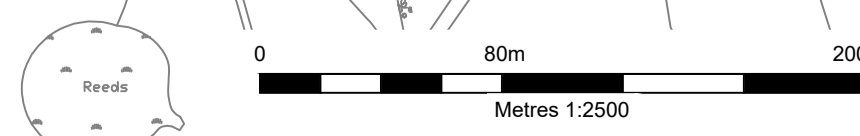

Project: Open Access 21/01/24 - Through EIA Development Support/000 - Drawing/Design for Client/Review/31/04/2024/01/NLGP/Works Plans C7 DWG

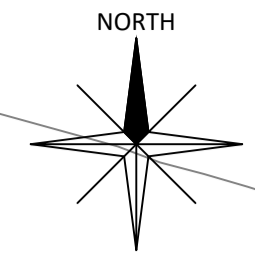
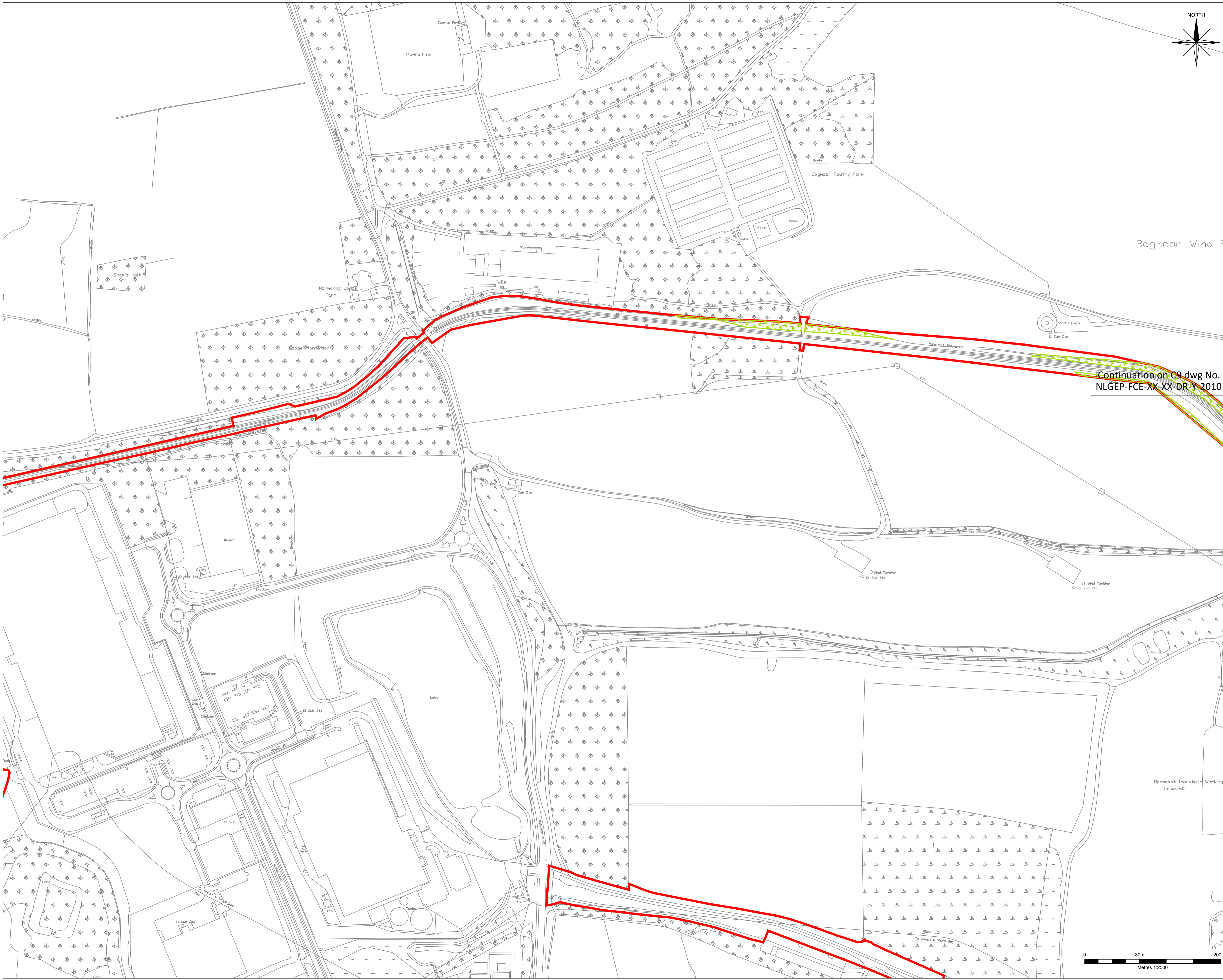

Planning Act 2008
The Infrastructure Planning
(Applications: Prescribed forms and Procedure) Regulations 2009
Regulation: 5(2)(j)

NOTES
OS Licensing information for OS CAD/GIS & raster data orders -
© crown copyright and database rights 2021 OS Licence 100035409

LEGEND
ORDER LIMITS

WORK	DESCRIPTION	LIMITS OF DEVIATION
WORK No. 12	LANDSCAPING AND ECOLOGICAL WORKS	

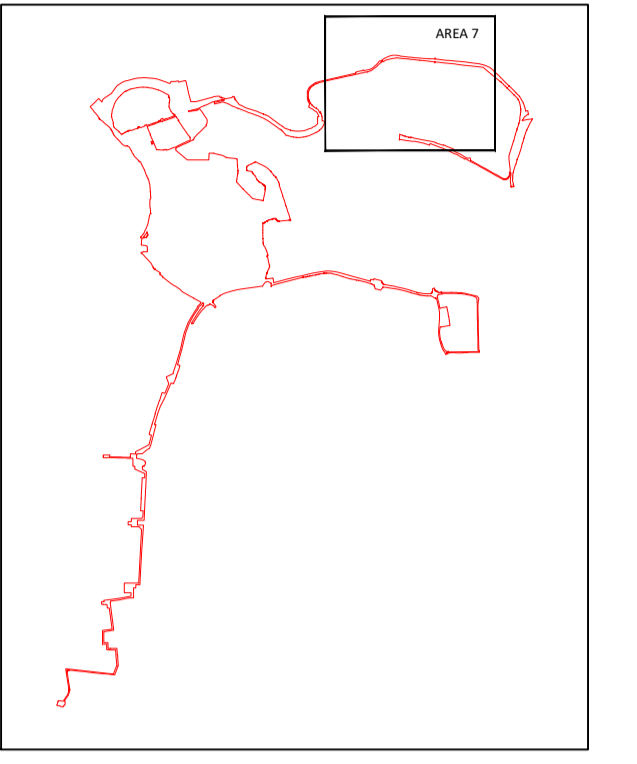

KEY PLAN

Continuation on C9 dwg No.
NLGEP-FCE-XX-XX-DR-Y-2010

PO	FOR DCO SUBMISSION	17.02.22	AO1	DTW/CAB
Rev	Description	Date	Iss'd	Rev'd

DCO SUBMISSION

Project Stage

INFORMATION

Status of Drawing

Client



Level 33, Euston Tower, 296 Euston Road,
London, NW1 3DP



Client: NORTH LINCOLNSHIRE GREEN ENERGY PARK LTD

Consultant: FICHTNER CONSULTING ENGINEERS

Project: NORTH LINCOLNSHIRE GREEN ENERGY PARK

Org Title: WORKS PLANS C8

Planning Inspectorate No. EN010116 Scale: A1

Drawn/Designed By: AO1 Checked By: DTW Approved By: CAB

Drawing No. NLGEP-FCE-XX-XX-DR-Y-2009 Revision PO

As per Open Access 21/03/14 - Through EIV Development Support/000 - Drawing/Design for Client Review/31/03/2021/NLGP/Notes/Plan C8/1.dwg

Continuation on C8 dwg No.
NLGEP-FCE-XX-XX-DR-Y-2009

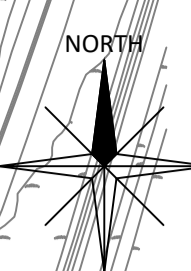

Planning Act 2008
The Infrastructure Planning
(Applications: Prescribed forms and Procedure) Regulations 2009
Regulation: 5(2)(j)

NOTES
OS Licensing information for OS CAD/GIS & raster data orders -
© crown copyright and database rights 2021 OS Licence 100035409

LEGEND
ORDER LIMITS

WORK	DESCRIPTION	LIMITS OF DEVIATION
WORK No. 12	LANDSCAPING AND ECOLOGICAL WORKS	

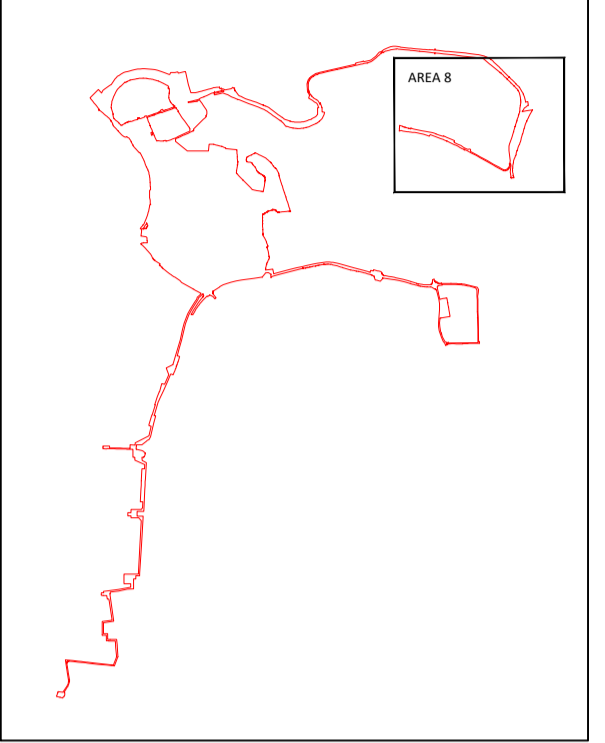

KEY PLAN

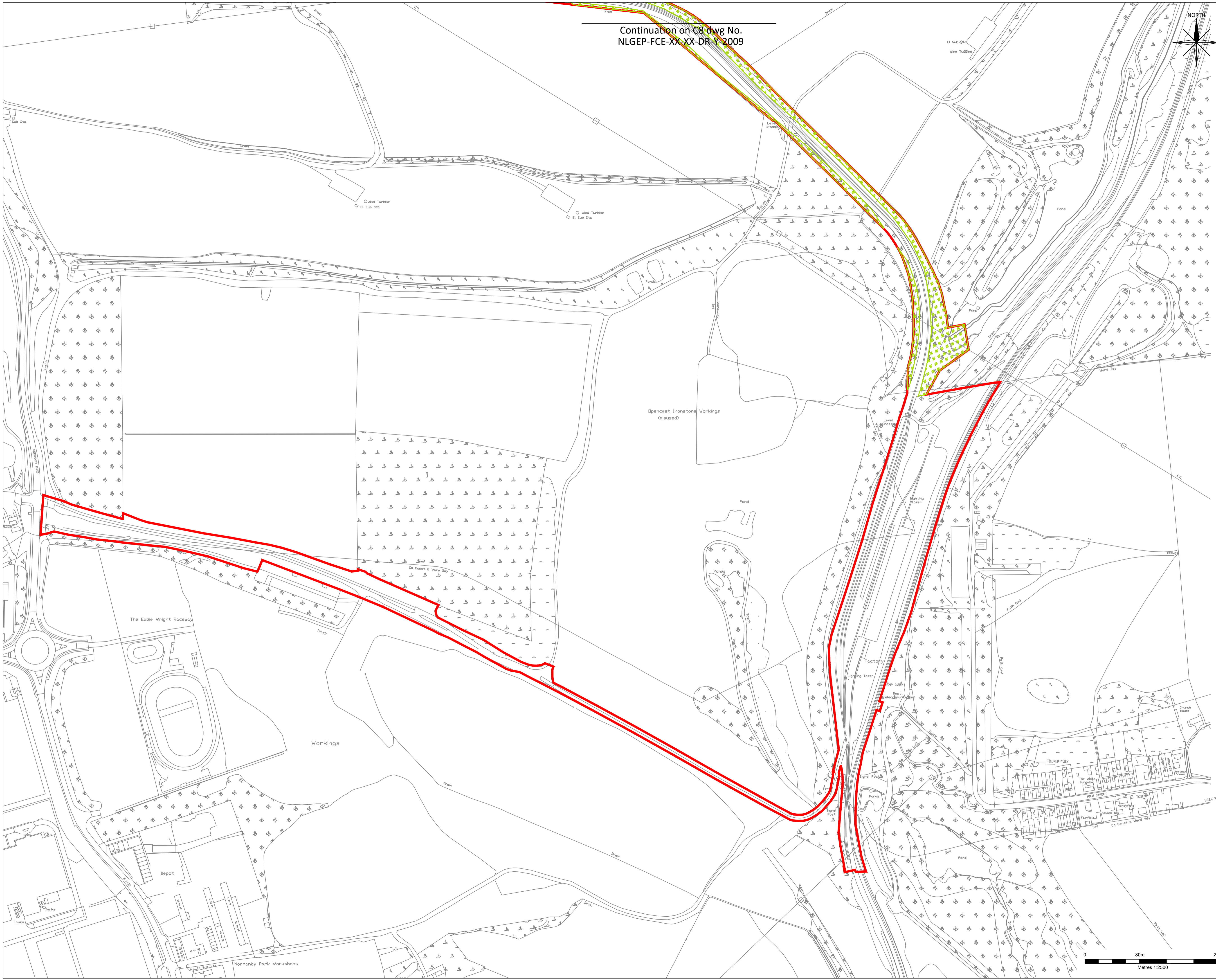

PO	FOR DCO SUBMISSION	17.02.22	AO1	DTW/CAB
Rev	Description	Date	Iss'd	Rev'd

DCO SUBMISSION

Project Stage

INFORMATION

Status of Drawing

Client

Level 33, Euston Tower, 296 Euston Road, London, NW1 3DP

LD A DESIGN GSDA FICHTNER
ERM

BURO HAPPOLD northern planners bowland ecology

Client: NORTH LINCOLNSHIRE GREEN ENERGY PARK LTD
Consultant: FICHTNER CONSULTING ENGINEERS
Project: NORTH LINCOLNSHIRE GREEN ENERGY PARK
Dwg Title: WORKS PLANS C9

Planning Inspectorate No. EN010116	Scale@A1 1:2500	
Drawn/Designed By: AO1	Checked By: DTW	Approved By: CAB
Drawing No. NLGEP-FCE-XX-XX-DR-Y-2010	Revision PO	

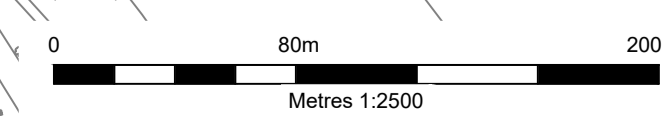

As per Open Space 21/01/14 - Through EIV Development Support/000 - Drawing/Design for Client Review/31/04/2020/01 NLGEP Works Plans C9 DWG